

CUSTOMER PART No.

CUSTOMER

**CAN ART STD.**

DIE No.

ES05764

DESCRIPTION

CHANNEL

PROPOSAL No.

S-12442

NOTE: BREAK ALL CORNERS WITH 0.015" (.38 MM) RADIUS UNLESS OTHERWISE NOTED. STANDARD TOLERANCES TO APPLY UNLESS OTHERWISE SPECIFIED.

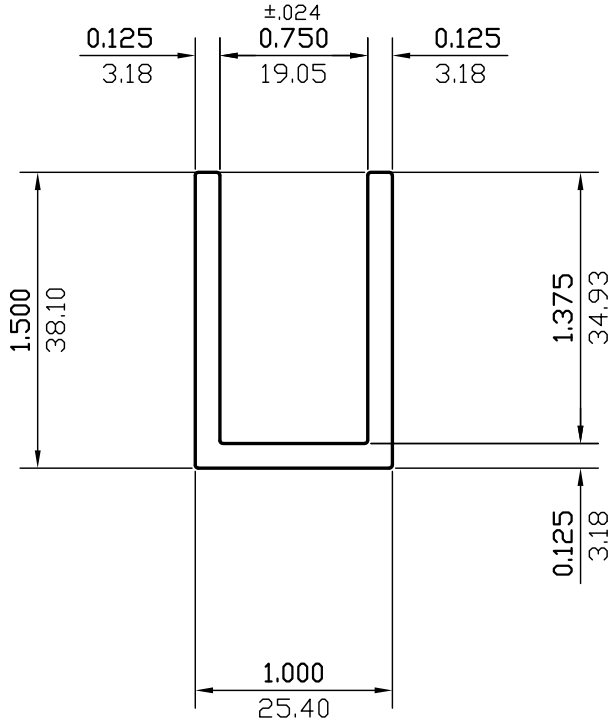

WALL THICKNESS AS SHOWN EXCEPT AS SHOWN

DATE	REV	DESCRIPTION	BY
03/20/23	1	REMOVED EXPOSED SURFACES AND ALLOY	JASON
EST.AREA	0.469	IN. <sup>2</sup>	EST.AREA 302.297
			MM. <sup>2</sup>
EST.WT.	0.553	LBS/FT.	EST.WT. 0.823
			KG/M.
EST.PER.	7.698	IN.	EST.PER. 195.542
			MM.
OUT PER.		IN.	OUT PER.
			MM.
C.C.D.	1.778	IN.	C.C.D. 45.158
			MM.
FACTOR	14	FINISH	M/F
		ALLOY & TEMP.	
CKD BY	SCALE	1:1	DWN BY C.P. DATE 06/03/2002

**CAN ART**

ALUMINUM EXTRUSION INC.

85 PARKSHORE DRIVE  
BRAMPTON, ONT L6T 5M1  
TEL. NO. (905) 791-1464  
FAX NO. (905) 791-9151  
E-MAIL: canart@canart.com

THIS DRAWING IS NOT NECESSARILY A COPY OF YOUR ORIGINAL. PLEASE APPROVE DIMENSIONS AND TOLERANCES INDICATED. CAN ART ASSUMES NO RESPONSIBILITY EITHER TECHNICAL OR LEGAL FOR HAVING THIS SHAPE MADE. THE CUSTOMER AGREES TO FULLY PROTECT CAN ART ALUMINUM FROM CLAIMS OF OTHERS RESULTING FROM THIS SHAPE.

SIGNED: \_\_\_\_\_ DATE: \_\_\_\_\_